



Venue Details



PRIVATE VENUES

	Ticket Price Per Person	Required Guest Count	Included Items	View	Location	Dress Code
Keeneland Room	\$175	76	Admission, Permit Parking, Program, Buffet Lunch	Race Track	5th Floor	Business Formal
Stakes Lounge at the Lafayette Room	\$160	68	Admission, Permit Parking, Program, Reception Style Lunch	Race Track	4th Floor	Business Formal
Life Members Room <i>(Weds/Thurs only)</i>	\$100	28	Admission, Permit Parking, Program, Clubhouse Access, Food and Beverage Purchased Separately	Paddock	2nd Floor Clubhouse	Business Formal
Standard Corporate Suite	\$185	12	Admission, Permit Parking, Program, Clubhouse Access, Food and Beverage Purchased Separately	Race Track	Grandstand 4th Floor	Business Formal
Large Corporate Suite	\$185	20	Admission, Permit Parking, Program, Clubhouse Access, Food and Beverage Purchased Separately	Race Track	Grandstand 4th Floor	Business Formal

PUBLIC VENUES

	Ticket Price	Table Size	Included Items	View	Location	Dress Code
Lexington/Kentucky Room	Weds-Thurs \$100 Fri, Sat, Sun \$125	4, 6	Admission, Program, Buffet Lunch	Race Track	4th Floor	Business Formal
Phoenix Room	Weds-Thurs \$80 Fri, Sat, Sun \$100	2, 4, 6	Admission, Program, Buffet Lunch	Paddock	4th Floor	Business Casual
Reserved Grandstand	Weds-Thurs \$15 Fri, Sat, Sun \$25	N/A	Admission, Reserved Grandstand Seat	Race Track	2nd & 3rd Floors	None
General Admission	Weds-Thurs \$7 Fri, Sat, Sun \$10	N/A	Admission	N/A	N/A	None

Keeneland Room



Primarily utilized as a backdrop for sponsors on their race day, the **Keeneland Room** is one of our most opulent settings with magnificent views of the race track as well as a private rooftop patio. The Keeneland Room is a truly lavish venue to entertain guests while they enjoy racing at its finest. Enjoy watching the races from the private dining room or trackside balcony!

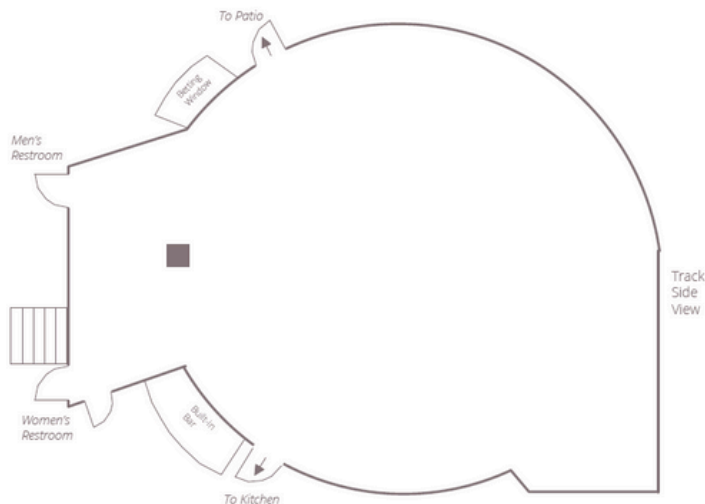

Venue

Ticket Price | \$175 per person

Venue Capacity | 76

Required number of tickets purchased paid in full at time of reservation

Dress Code | Business Formal

Location | Grandstand, 5th Floor

View | Race Track

Guest Tables |

Final Table Layout to be Agreed Upon by Host and Keeneland.

Chairs | Padded Rattan

Linens & Napkins | Ivory

China, Silverware, Glassware

Ivory China, Hammered

Silverware, Varied Glassware

Race Day

Included Items

Buffet Lunch or A La Carte

Tickets | General Admission

Parking | Permit Parking

Programs

Day-Of Items for Purchase

Beverage | Alcoholic and

Non-Alcoholic Options

Other Details

- Televisions are Located in Venue
- Private Mutuel Tellers
- BETologists, Professional Handicappers and Gifting are Available Upon Request
- Meetings Must Conclude by Noon

Stakes Lounge

at the Lafayette Room



Enjoy a panoramic view of our race track and rolling bluegrass countryside from the **Stakes Lounge at the Lafayette Room**. Tiered seating and 4th floor balcony access provides wonderful views for all of your guests to experience the pure excitement of the race meet.

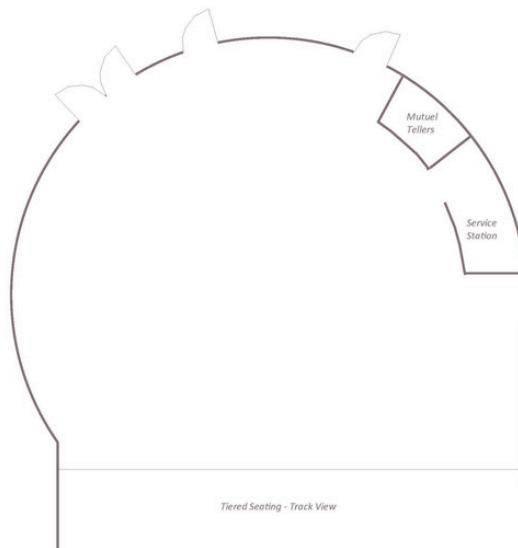

Venue

Ticket Price | \$160 per person

Venue Capacity | 68

Required number of tickets purchased paid in full at time of reservation

Dress Code | Business Formal

Location | Grandstand, 4th Floor

View | Race Track

Reception Style Set-up

Linens & Napkins | Ivory

China, Silverware, Glassware |

Ivory China, Hammered

Silverware, Varied Glassware

Race Day

Included Items

Food | Reception Style

Tickets | General Admission

Parking | Permit Parking

Programs

Day-Of Items for Purchase

Beverage | Alcoholic and

Non-Alcoholic Options

Other Details

- Televisions are Located in Venue
- Private Mutuel Tellers
- BETologists, Professional Handicappers and Gifting are Available Upon Request
- Meetings are Not Permitted

Life Members Room



The **Life Members Room** offers a picturesque view of the Paddock as well as upscale accommodations within the second floor of the Keeneland Clubhouse. Guests will have access to the Clubhouse Grandstand and Clubhouse Lawn so they can experience the excitement of live racing from the track!

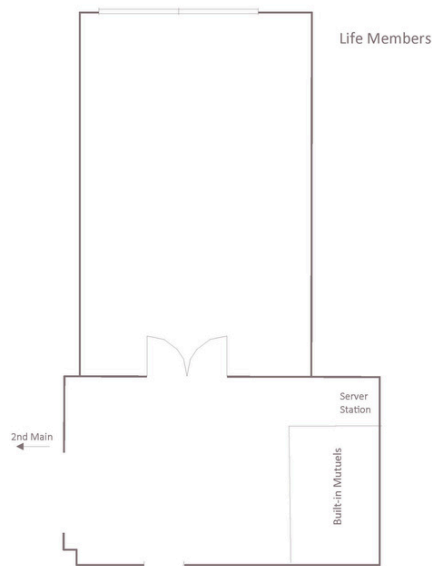

Venue

Ticket Price | \$100 per person
available Weds/Thurs only

Venue Capacity | 28

*Required number of tickets purchased
paid in full at time of reservation*

Dress Code | Business Formal

Location | Clubhouse, 2nd Floor

View | Paddock

Guest Tables

(2) 6-Top Tables, (4) 4-Top Table

Chairs | Padded Rattan

Linens & Napkins | Ivory

China, Silverware, Glassware

Off-White China, Hammered

Silverware, Varied Glassware

Race Day

Included Items

Tickets | Clubhouse Guest

Parking | Permit Parking

Programs

**Food and Beverage Available
for Purchase Day-of**

Other Details

- Televisions are Located in Venue
- Mutuel Tellers are Located in the Clubhouse
- BETologists, Professional Handicappers and Gifting are Available Upon Request
- Meetings are Not Permitted

Standard Corporate Suite



The perfect venue for entertaining, the **Corporate Suites** have large windows that offer a spectacular view of the race track from the fourth floor. Guests will be provided Clubhouse Guest access which allows them to experience the races from the Clubhouse Lawn throughout the day.

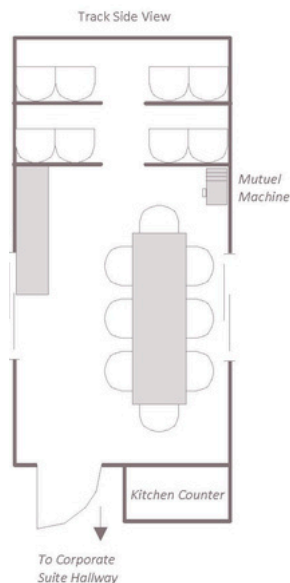

Venue

Ticket Price | \$185 per person

Food and Beverage

Minimum | \$750

Required Guest Count | 12

Required number of tickets purchased paid in full at time of reservation

Dress Code | Business Formal

Location | Grandstand, 4th Floor

View | Race Track

Guest Tables |

Table for 8, Tiered Seating for 8

Chairs | Padded Rattan

Linens & Napkins | Ivory, Green

China, Silverware, Glassware

Ivory China, Hammered

Silverware, Varied Glassware

Race Day

Included Items

Tickets | Clubhouse Guest

Parking | Permit Parking

Programs

Food and Beverage Available for Purchase Day-of

Other Details

- Televisions are Located in Venue
- Private Mutuel Machine Inside Suite, as well as Nearby Tellers
- BETologists, Professional Handicappers and Gifting are Available Upon Request
- Meetings are Not Permitted

Large Corporate Suite



The perfect venue for entertaining, the **Corporate Suites** have large windows that offer a spectacular view of the race track from the fourth floor. Guests will be provided Clubhouse Guest access which allows them to experience the races from the Clubhouse Lawn throughout the day.

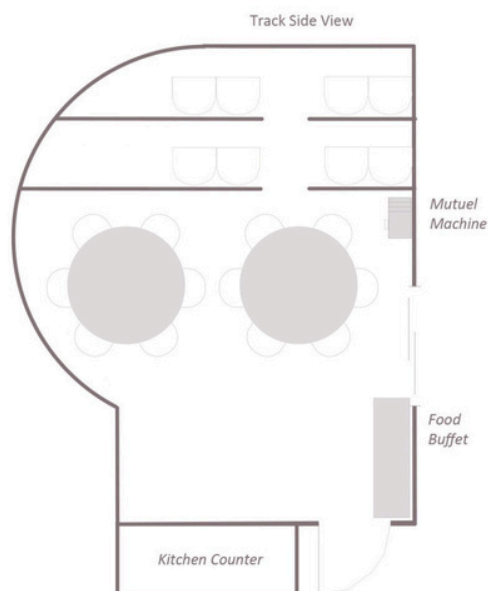

Venue

Ticket Price | \$185 per person

Food and Beverage

Minimum | \$1,250

Required Guest Count | 20

Required number of tickets purchased paid in full at time of reservation

Dress Code | Business Formal

Location | Grandstand, 4th Floor

View | Race Track

Guest Tables

2 Tables of 6, Tiered Seating for 8

Chairs | Padded Rattan

Linens & Napkins | Ivory, Green

China, Silverware, Glassware

Ivory China, Hammered

Silverware, Varied Glassware

Race Day

Included Items

Tickets | Clubhouse Guest

Parking | Permit Parking

Programs

Food and Beverage Available for Purchase Day-of

Other Details

- Televisions are Located in Venue
- Private Mutuel Machine Inside Suite, as well as Nearby Tellers
- BETologists, Professional Handicappers and Gifting are Available Upon Request
- Meetings are Not Permitted

Lexington/Kentucky Room



Located on the fourth floor overlooking the scenic Keeneland track, the **Lexington/Kentucky Room** is an exceptional dining option for a day at the races! Guests can come and go from the reserved table throughout the day to watch horses in the paddock or the races on the track apron!



Venue

Ticket Price Per Person |

Wednesday/Thursday \$100

Friday/Saturday/Sunday \$125

Dress Code | Business Formal

Location | 4th Floor

View | Race Track

Guest Tables | Table for 4 or 6

Chairs | Padded Rattan

Linens & Napkins | Ivory

China, Silverware, Glassware

Ivory China, Hammered

Silverware, Varied Glassware

Availability

Group Sales

Wed/Thurs/Sun : 24 - 100 Guests

Public Sales

Wed/Thurs : up to 18 Guests

Fri/Sat/Sun : up to 6 Guests

Race Day

Included Items

Food | Buffet Lunch

Tickets | General Admission

Parking | Public Parking

Programs

Day-Of Items for Purchase

Beverage | Alcoholic and

Non-Alcoholic Options

Other Details

- Televisions are Located in Venue
- Mutuel Tellers
- BETologists, Professional Handicappers and Gifting are Available Upon Request
- Meetings are Not Permitted

Phoenix Room



The **Phoenix Room** overlooks the walking ring where horses are mounted before entering to the track for the races. Guests can come and go from this room, and the tables are reserved for the entire day. Place bets from the private tellers in the dining room, then watch the races from the fourth floor balcony or track apron!



Venue

Ticket Price Per Person |

Wednesday/Thursday \$80

Friday/Saturday/Sunday \$100

Dress Code | Business Casual

Location | 4th Floor

View | Paddock

Guest Tables | Table for 4 or 6

Chairs | Padded Rattan

Linens & Napkins | Ivory

China, Silverware, Glassware

Ivory China, Hammered

Silverware, Varied Glassware

Availability

Group Sales

Wed/Thurs/Sun : 24 - 100 Guests

Public Sales

Wed/Thurs : up to 18 Guests

Fri/Sat/Sun : up to 6 Guests

Race Day

Included Items

Food | Buffet Lunch

Tickets | General Admission

Parking | Public Parking

Programs

Day-Of Items for Purchase

Beverage | Alcoholic and

Non-Alcoholic Options

Other Details

- Televisions are Located in Venue
- Mutuel Tellers
- BETologists, Professional Handicappers and Gifting are Available Upon Request
- Meetings are Not Permitted

Reserved Grandstand



Enjoy all the benefits of being outside with the comfort of a covered seat with **Reserved Grandstand** seating. Keeneland's Reserved Grandstand seats gets you and your friends trackside, close to the action and excitement of the races. These seats are conveniently located near concession stands, restrooms, bars and mutuel windows.

The ticket office can assist with purchasing \$10 food/drink vouchers and betting vouchers ahead of time to add a level of hospitality to the race day!



Venue

Ticket Price Per Person |

Wednesday/Thursday \$15

Friday/Saturday/Sunday \$25

Dress Code | None

Location | Grandstand

View | Race Track

Availability

Group Sales

Wed/Thurs/Sun : 24+ Guests

Public Sales

Wed/Thurs : up to 12 Guests

Fri/Sat/Sun : up to 8 Guests

Race Day

Tickets | General Admission

Parking | Public Parking

Beverage | Concession Stands

Food | Concession Stands

Other Details

- Televisions are Located in Grandstand
- Mutuel Tellers Located in Grandstand
- Meetings are not Permitted

General Admission



Keeneland's **General Admission** ticket allows fans to take advantage of open seating on the Track Apron benches, North Terrace and open indoor seating. Take in the excitement of the races up close along the rail or study the horses warming up in the paddock. Concessions, beverages and mutuel windows can be found just inside the grandstand.



Venue

Ticket Price Per Person |

Wednesday/Thursday \$7

Friday/Saturday/Sunday \$10

Dress Code | None

Location | Grandstand

View | Race Track

Availability | Wednesday-Sunday

Availability

Public Sales

Wed/Thurs : up to 12 Guests

Fri/Sat/Sun : up to 8 Guests

**Not available to Groups*

Race Day

Tickets | General Admission

Parking | Public Parking

Beverage | Concession Stands

Food | Concession Stands

Other Details

- Televisions are Located in Grandstand
- Mutuel Tellers Located in Grandstand
- Meetings are Not Permitted

